

ADDENDUM 01

Project Name: Oceanside Place - AHU Replacement - 2017
Date: July 25, 2017
Client: Regional District of Nanaimo
Project Number: 17177-N
Written By: Mike Warrington
Addendum Number: 01
Pages: 1
Attachments: 1

GENERAL

CLARIFY: To clarify, the structural details on drawing S101 refer only to AHU-1.

Refer to SPECIFICATIONS

Refer to SECTION 15020 – Mechanical Materials and Equipment

ADD: Add Engineered Air, Sterling and ICE Western as approved equal manufacturers for “Air Make-up Units – Outdoor Gas Fired”.

Refer to STRUCTURAL DRAWINGS

Refer to Structural Drawing S101 (1 Page Attached)

REVISE: Revise drawing as shown. Changes are shown in revision clouds.

END OF ADDENDUM 01

STRUCTURAL STEEL HEL-022

1. ALL STEEL WORK SHALL BE IN ACCORDANCE WITH CSA-S16-09 AND THE REVIEWED SHOP DRAWINGS.
2. THE STEEL FABRICATOR SHALL SUBMIT SHOP DRAWINGS AS SPECIFIED UNDER 'SUBMITTALS' TO THE PROJECT ENGINEER FOR REVIEW PRIOR TO FABRICATION. SHOP DRAWINGS SHALL INDICATE ALL DETAILS, FASTENERS, MATERIAL SPECIFICATIONS, FINISHES AND DESIGN LOADS.
3. A COPY OF THE FABRICATOR'S CANADIAN WELDING BUREAU CERTIFICATES SHALL BE INCLUDED WITH THE SHOP DRAWING SUBMISSION.
4. ALL WELDING SHALL BE IN ACCORDANCE WITH CSA W59-03 (R2008) AND SHALL BE PERFORMED BY FABRICATORS "FULLY APPROVED" BY THE CANADIAN WELDING BUREAU UNDER CSA W55.3-08. FABRICATING SHOP TO HAVE A MINIMUM DIVISION 2.1 CERTIFICATION BY THE CANADIAN WELDING BUREAU TO THE REQUIREMENTS OF CSA W47.1-09 AND CSA W55.3-08 FOR RESISTANCE WELDING OF STRUCTURAL COMPONENTS. THE FABRICATOR SHALL SUBMIT PROOF OF CERTIFICATION PRIOR TO START OF WORK.
5. ALL WELDING ELECTRODES SHALL CONFORM TO CSA W48-06 (R2011).
6. CONNECTIONS DETAILED ON THESE STRUCTURAL DRAWINGS SHALL BE FABRICATED AND ERECTED AS SHOWN. ALTERNATIVES MAY BE CONSIDERED AT THE SOLE DISCRETION OF THE STRUCTURAL ENGINEER OF RECORD BUT MUST BE PRE-APPROVED BY SAME. WHERE AN ALTERNATIVE IS APPROVED IT SHALL BE AT NO ADDITIONAL COST TO THE OWNER AND SHALL NOT NEGATIVELY IMPACT THE CONSTRUCTION SCHEDULE.
7. FABRICATOR SHALL INCREASE WELD SIZES TO ACCOMMODATE SLOT WIDTHS SO THAT LEG SIZE AS SPECIFIED IS FULLY ON STEEL CONNECTION ELEMENT. FINAL WELD SIZE TO BE SHOWN ON THE SHOP DRAWINGS.
8. EXCEPT PARTS OF MEMBERS TO BE EMBEDDED IN CONCRETE OR GALVANIZED OR UNLESS NOTED OTHERWISE ON THE DRAWINGS, ALL STEEL WORK SHALL BE SHOP PRIMED. PRIMING SHALL BE IN ACCORDANCE WITH CISC/CPMA-1-73g "QUICK DRYING PRIMER" WHEN NO TOP COAT IS REQUIRED AND IN ACCORDANCE WITH CISC/CPMA-2-75 WHEN A TOP COAT IS SPECIFIED. IF A TOP COAT IS SPECIFIED THE PRIMER SHALL BE SELECTED ENSURING COMPATIBILITY WITH THE SPECIFIED SYSTEM. ITEMS SPECIFIED TO BE GALVANIZED SHALL BE HOT DIPPED GALVANIZED TO ASTM A123/A123M, MINIMUM ZINC COATING OF 600g/sq.m. FIELD TOUCH-UP ALL ABRASIONS, SCRATCHES, WELDS OR BOLTS WITH GALVA-ON OR EQUIVALENT.
9. ALL EXTERIOR STEEL WORK AND STEEL PROTRUDING THROUGH THE BUILDING ENVELOPE SHALL BE HOT DIP GALVANIZED.
10. PROVIDE STRUCTURAL STEEL TO CSA G40.20-04/G40.21-04 (R2009) OR ASTM A992 WITH THE FOLLOWING GRADES:

CHANNELS AND ANGLES	300W (44W)
MISCELLANEOUS STEEL PLATES	300W (44W)
11. THE CONTRACTOR SHALL PROVIDE TEMPORARY BRACING DURING CONSTRUCTION. THE BRACING SHALL BE DESIGNED, INSTALLED AND MAINTAINED BY THE CONTRACTOR. THE BRACING SHALL BE REMOVED ONLY AFTER PERMANENT ROOF AND FLOOR DIAPHRAGMS, SHEAR WALLS AND BRACING ARE COMPLETE.
12. THE CONTRACTOR SHALL PROVIDE SEAL WELDED CLOSURE PLATES AT ALL OPEN ENDS OF EXTERIOR HSS COLUMNS. PLATE THICKNESS SHALL BE A MINIMUM OF 6 mm (1/4") UNLESS NOTED OTHERWISE.

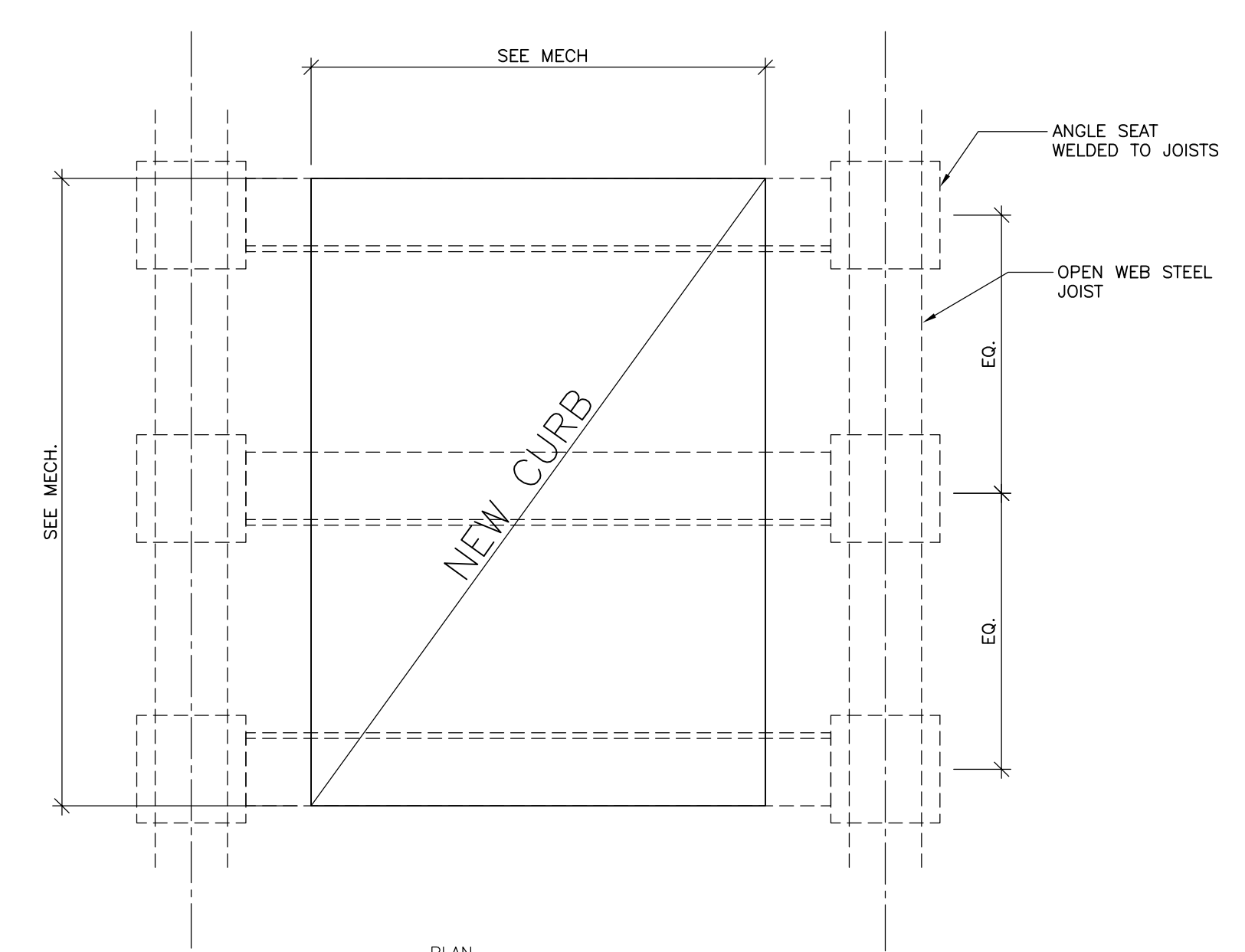
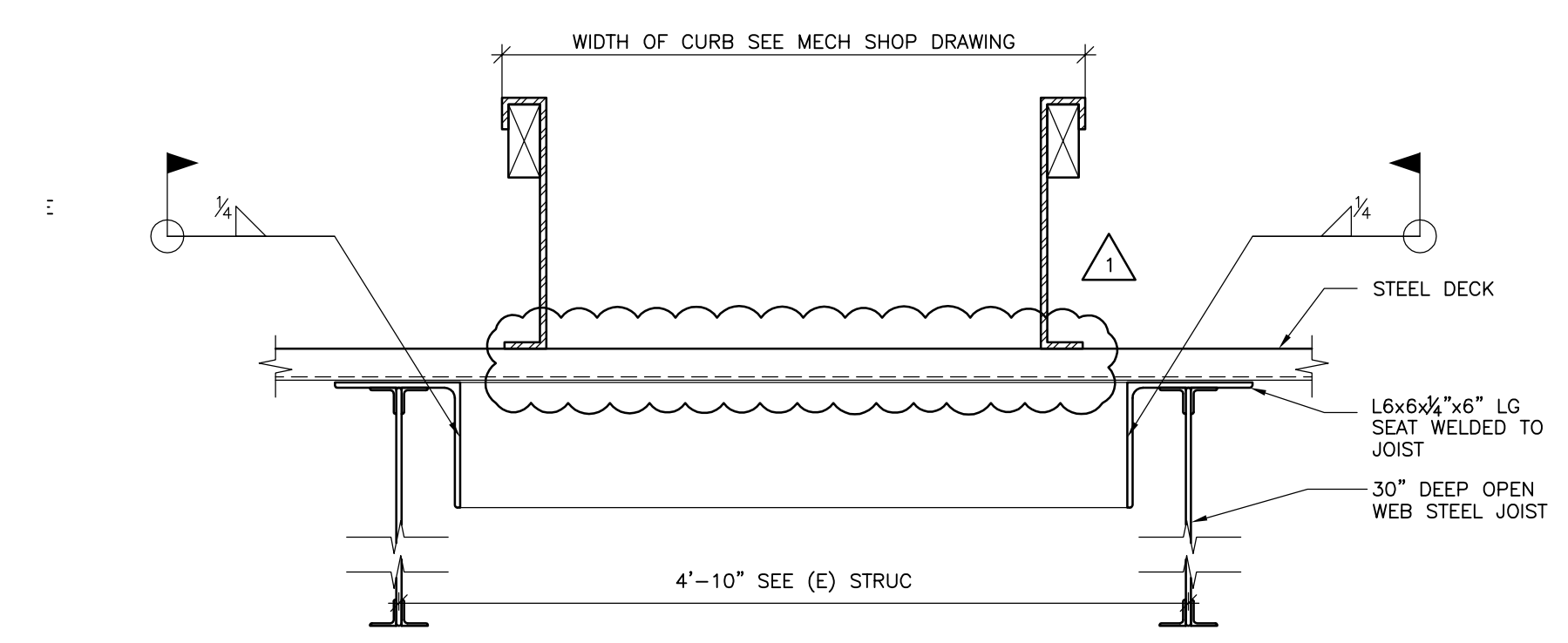
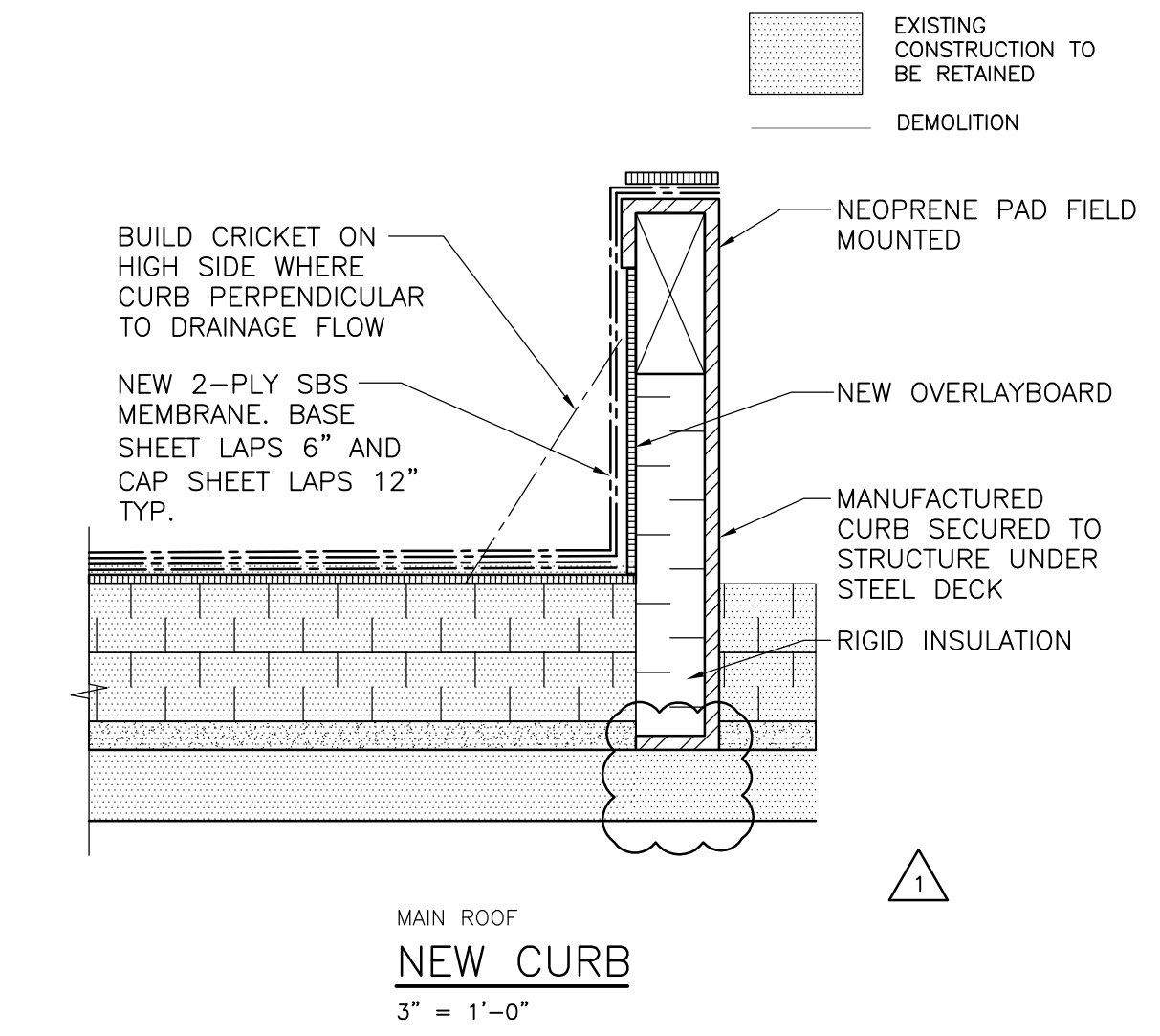
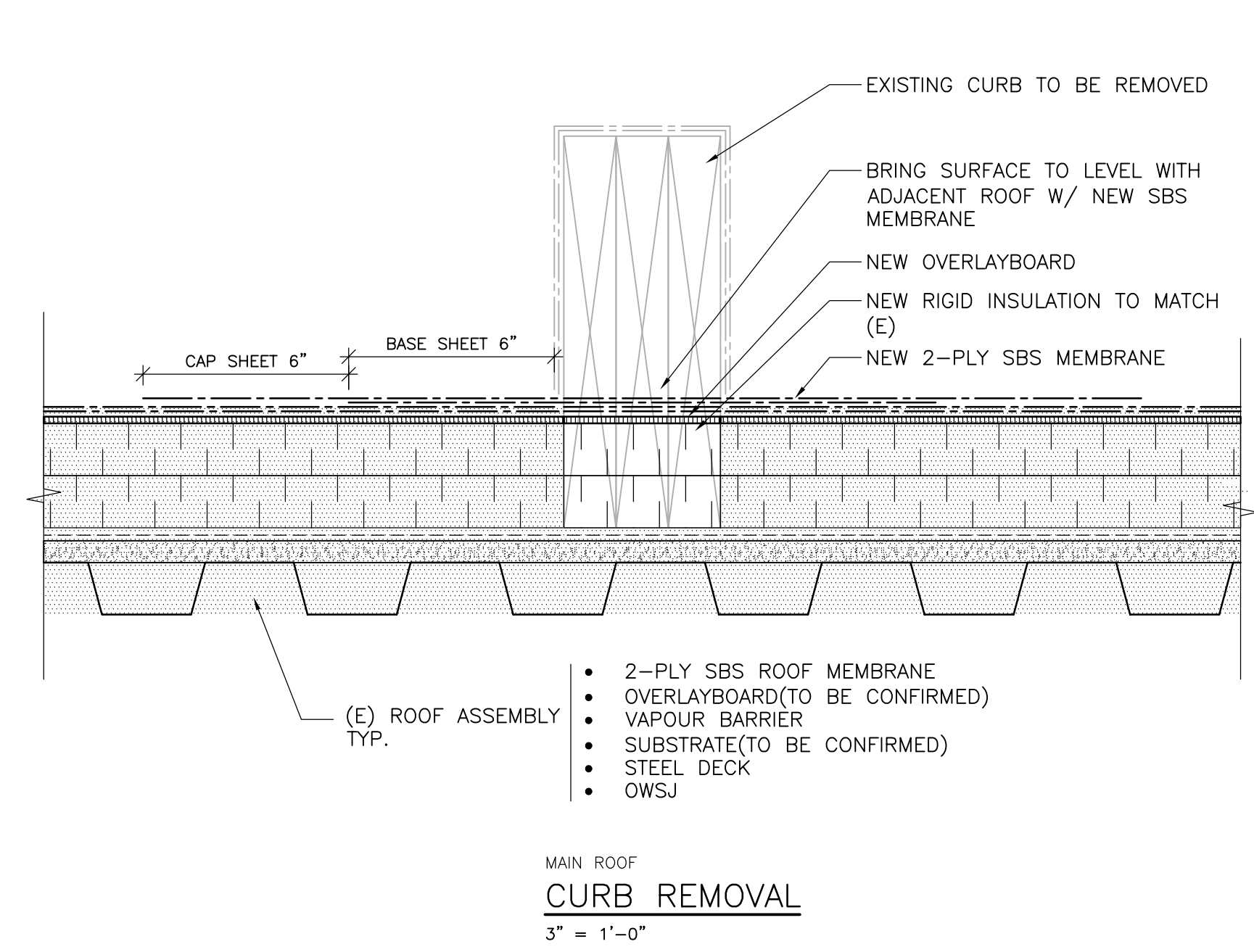

ISSUES		
No.	DATE	ISSUED FOR
1	2017.06.27	REVIEW
2	2017.07.06	CLIENT REVIEW
3	2017.07.17	TENDER
4	2017.07.25	ADDENDUM

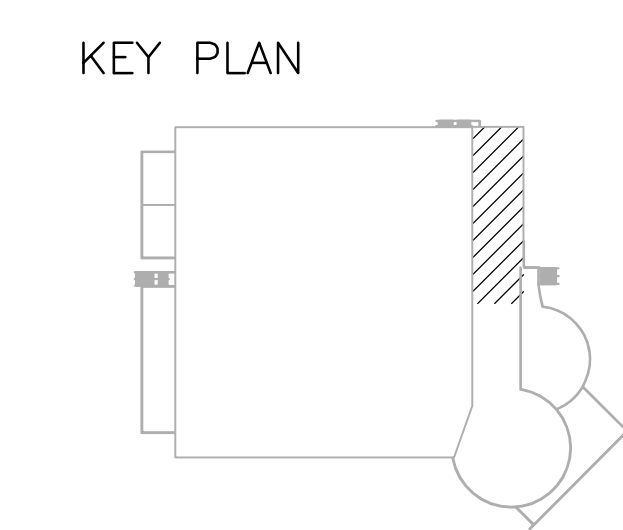

OCEANSIDE ARENA AHU UPGRADE

830 ISLAND HWY W PARKSVILLE, BC

HEROLD ENGINEERING
 3701 Shenton Rd, Nanaimo, BC V9T 2H1
 Tel: 250-751-8558 Fax: 250-751-8559
 Email: mail@heroldengineering.com

© Copyright reserved. This drawing remains the exclusive property of Herold Engineering Limited and may not be reused or reproduced without written consent of Herold Engineering Limited.

DETAILS NOTES	
DESIGNED JK	ENGINEER'S SEAL
DESIGN REVIEW	
DRAFTED VW	
DRAFTING REVIEW GB	
PROJECT No. 0417-059	CLIENT DRAWING No. n/a
SCALE AS SHOWN	PERMIT No. n/a
HEL DRAWING No. S101	REVISION 1