

Westurne Heights Water System

2
PL. 52066

PL.45420

1229

1
061
3857

3853

MARPLES ROAD

3852

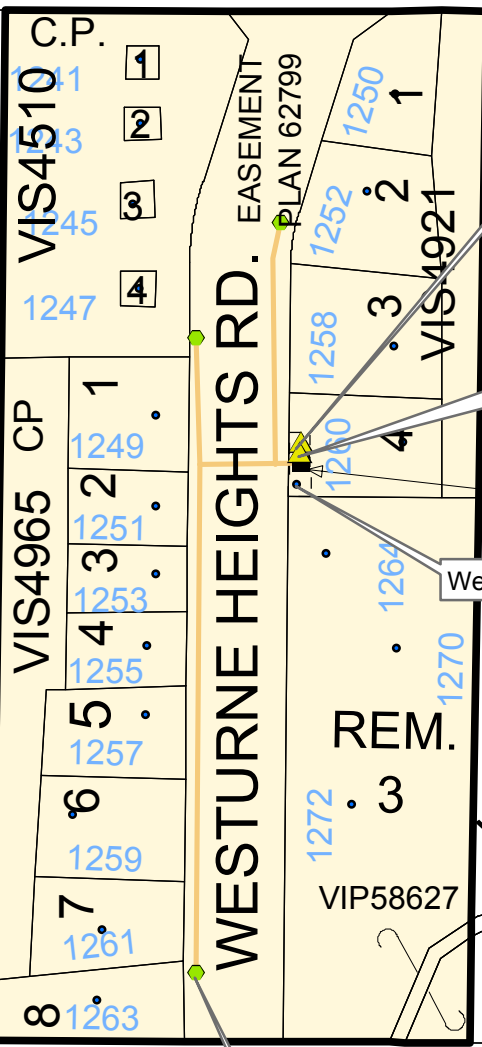

Cisterns (2)

2 Booster Pumps
2 Pressure Tanks
Pumphouse and
Treatment System

Well, Pump, Meter

Flushout
(Standpipe)

2
PLAN

62304

VIP



3790

3786

CROWN

- ▲ Cistern (2)
- Flush Out (Standpipe)
- Pumphouse
- 3" PVC Watermain
- Westurne Heights Water

40 20 0 40 Meters

5 2 4 9 5